



FLOWLINK 

PRODUCTS CATALOG WELD FITTINGS

SAS ECM COMPONENTS - FLOWLINK
165 avenue des cocardières - ZAC VIA DOMITIA - 34 160 Castries - France
contact@ecmcomponents.com - Phone: +33 (0) 4 67 61 12 02 - flowlinksa.com



INDEX

Weld Fittings

Introduction	
How To Order	3

1. Weld Fittings

1.1. Weld Fittings - Micro

1.1.1. HME - Micro Elbow 90°	4
1.1.2. HMRE - Micro Reducing Elbow 90°	4
1.1.3. HMVE - Micro Elbow 45°	4
1.1.4. HMT - Micro Tee	5
1.1.5. HMRT - Micro Reducing Tee	5
1.1.6. HMTB - Micro Tribow	5
1.1.7. HMC - Micro Cross	6
1.1.8. HMRU - Micro Reducing Union	6

1.2. Weld Fittings - Long

1.2.1. HLE - Long Elbow 90°	7
1.2.2. HLRE - Long Reducing Elbow 90°	7
1.2.3. HLT - Long Tee	8
1.2.4. HLRT - Long Reducing Tee	8
1.2.5. Long Reducing Union	9



1. WELD FITTINGS

Introduction

How To Order

Our weld fittings are ordered by part number as shown below.

Example : The following part number, HMGS-0804-DM-EP is designated for Micro Gland S, 1/2" UCR, 1/4" Tube O.D, Double Melting SS316L, Electro Polished.

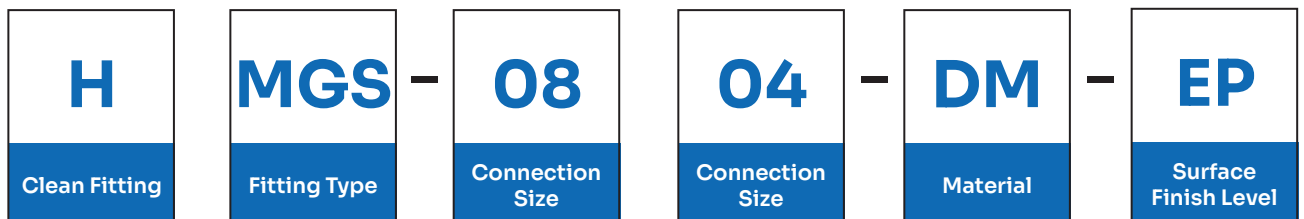

Fitting Type	Refer to the part number in the dimension table.
--------------	--

Connection Size							
Fractional (Inch) Tube O.D. Designation							
Tube O.D.	inch	1/8	1/4	3/8	1/2	3/4	1
	mm	3.17	6.35	9.52	12.7	19.05	25.4
Designator		02	04	06	08	12	16
UCR (Metal Face Seal) Size Designator							
UCR Size		1/4	1/2	3/4	1		
Designator		04	08	12	16		

Materials	
DM	SS316L - Double Melting
SM	SS316L - Single Melting
SL	SS316L
NI	Nickel

Surface Finish Level	
BA	BA - Bright Annealing
EP	EP - Electro Polished

1. WELD FITTINGS

1.1. Weld Fittings - Micro

1.1.1. HME - Micro Elbow 90°

Part No.	Tube O.D.D		Tube W.T.T		Dimensions (mm)		Body Cube	
	inch	mm	inch	mm	A	B	L	F
HME-02-	1/8	3.17	0.028	0.71	14.29	6.35	10.32	7.94
HME-04-	1/4	6.35	0.039	1				
HME-06-	3/8	9.52		1	17.46		11.91	11.11
HME-08-	1/2	12.7	0.049	1.24	20.64		13.5	14.29
HME-12-	3/4	19.05	0.065	1.65	27		16.67	20.65

1.1.2. HMRE - Micro Reducing Elbow 90°

Part No.	Tube O.D.D		Tube W.T.T		Tube O.D.D1		Tube W.T.T1		Dimensions (mm)		Body Cube	
	inch	mm	inch	mm	inch	mm	inch	mm	A	B	L	F
HMRE-0402-	1/4	6.35	0.039	1	1/8	3.17	0.028	0.71	14.29	6.35	10.32	7.94
HMRE-0604-	3/8	9.52		1	1/4	6.35	0.039	1	17.46		11.91	11.11
HMRE-0804-	1/2	12.7	0.049	1.24	1/4	6.35		1	20.64		13.5	14.29
HMRE-0806-	1/2	12.7	0.049	1.24	3/8	9.52		1				

1.1.3. HMVE - Micro Elbow 45°

Part No.	Tube O.D.D		Tube W.T.T		Dimensions (mm)			Body Cube
	inch	mm	inch	mm	A	B	L	F
HMVE-04-	1/4	6.35	0.039	1	11.96	6.35	10.32	7.94
HMVE-06-	3/8	9.52		1	14.21		11.91	11.11
HMVE-08-	1/2	12.7	0.049	1.24	16.46		13.5	14.29

HME

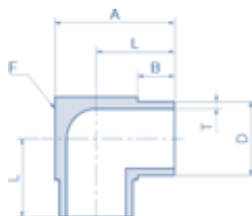

HMRE



HMVE

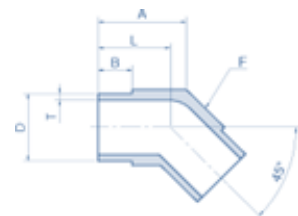

Dimensions are for reference only and are subject to change without prior notice.

1. WELD FITTINGS

1.1. Weld Fittings - Micro

1.1.4. HMT - Micro Tee

Part No.	Tube O.D.D		Tube W.T.T		Dimensions (mm)			Body Cube
	inch	mm	inch	mm	A	B	L	
HMT-02-	1/8	3.17	0.028	0.71	20.64	6.35	10.32	7.94
HMT-04-	1/4	6.35	0.039	1				
HMT-06-	3/8	9.52		1	23.81		11.91	11.11
HMT-08-	1/2	12.7	0.049	1.24	26.99		13.5	14.29
HMT-12-	3/4	19.05	0.065	1.65	33.35		16.67	20.65

1.1.5. HMRT - Micro Reducing Tee

Part No.	Tube O.D.D		Tube W.T.T		Tube O.D.D1		Tube W.T.T1		Dimensions (mm)			Body Cube
	inch	mm	inch	mm	inch	mm	inch	mm	A	B	L	
HMRT-0402-	1/4	6.35	0.039	1	1/8	3.17	0.028	0.71	20.64	6.35	10.32	7.94
HMRT-0604-	3/8	9.52		1	1/4	6.35	0.039	1	23.81			
HMRT-0804-	1/2	12.7	0.049	1.24	1/4	6.35		1	26.99		13.5	14.29
HMRT-0806-	1/2	12.7	0.049	1.24	3/8	9.52	1					

1.1.6. HMTB - Micro Tribow

Part No.	Tube O.D.D		Tube W.T.T		Dimensions (mm)		Body Cube
	inch	mm	inch	mm	B	L	
HMTB-04-	1/4	6.35	0.039	1	6.35	10.32	7.94
HMTB-06-	3/8	9.52					
HMTB-08-	1/2	12.7	0.049	1.24			

HMT

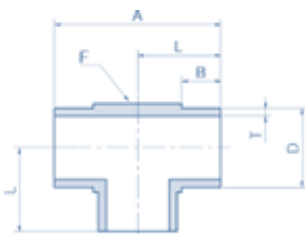

HMRT

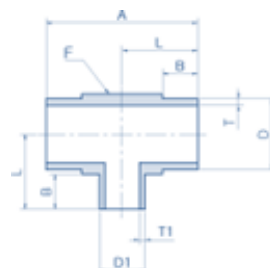

HMTB

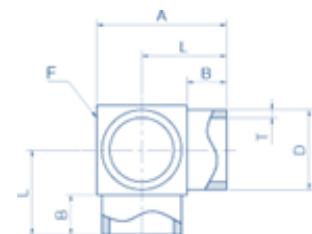

1. WELD FITTINGS

1.1. Weld Fittings - Micro

1.1.7. HMC - Micro Cross

Part No.	Tube O.D.D		Tube W.T.T		Dimensions (mm)			Body Cube
	inch	mm	inch	mm	A	B	L	F
HMC-04-	1/4	6.35	0.039	1	20.64	6.35	10.32	7.94
HMC-06-	3/8	9.52			23.81		11.91	11.11
HMC-08-	1/2	12.7	0.049	1.24	26.99		13.5	14.29

1.1.8. HMRU - Micro Reducing Union

Part No.	Tube O.D.D		Tube W.T.T		Tube O.D.D1		Tube W.T.T1		Dimensions (mm)	
	inch	mm	inch	mm	inch	mm	inch	mm	B	L
HMRU-0402-	1/4	6.35	0.039	1	1/8	3.17	0.028	0.71	6.35	19.05
HMRU-0604-	3/8	9.52		1	1/4	6.35	0.039	1		
HMRU-0804-	1/2	12.7	0.049	1.24	1/4	6.35		1		
HMRU-0806-	1/2	12.7	0.049	1.24	3/8	9.52		1		
HMRU-1204-	3/4	19.05	0.065	1.65	1/4	6.35	1			
HMRU-1206-	3/4	19.05	0.065	1.65	3/8	9.52	1			
HMRU-1208-	3/4	19.05	0.065	1.65	1/2	12.7	0.049	1.24		

HMC



HMRU

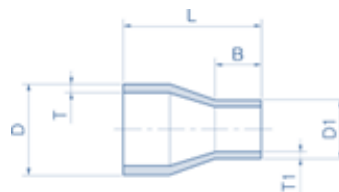

1. WELD FITTINGS

1.2. Weld Fittings - Long

1.2.1. HLE - Long Elbow 90°

Part No.	Tube O.D.D		Tube W.T.T		Dimensions (mm)			Body Cube
	inch	mm	inch	mm	B	L	F	
HLE-04-	1/4	6.35	0.039	1	19	20	25	9
HLE-06-	3/8	9.52		1				11
HLE-08-	1/2	12.7	0.049	1.24		27	15	
HLE-12-	3/4	19.05	0.065	1.65		31.5	22	
HLE-16	1	25.4	0.049	1.65		34	30	

1.2.2. HLRE - Long Reducing Elbow 90°

Part No.	Tube O.D.D		Tube W.T.T		Tube O.D.D1		Tube W.T.T1		Dimensions (mm)			Body Cube
	inch	mm	inch	mm	inch	mm	inch	mm	B	L	F	
HLRE-0604-	3/8	9.52	0.039	1	1/4	6.35	0.039	1	19	25	11	
HLRE-0804-	1/2	12.7	0.049	1.24	1/4	6.35						
HLRE-0806-	1/2	12.7	0.049	1.24	3/8	9.53				27	15	
HLRE-1204-	3/4	19.05	0.065	1.65	1/4	6.35				31.5	22	
HLRE-1206-	3/4	19.05	0.065	1.65	3/8	9.52						
HLRE-1208-	3/4	19.05	0.065	1.65	1/2	12.7	0.049	1.24				

HLE

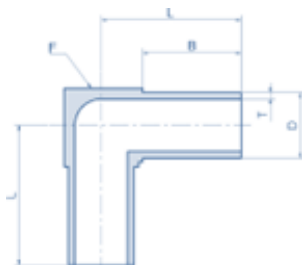

HLRE

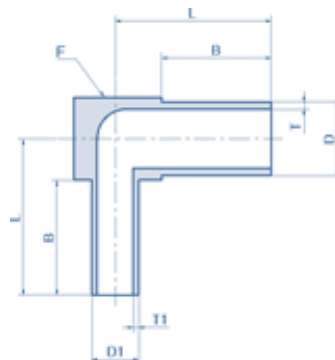

1. WELD FITTINGS

1.2. Weld Fittings - Long

1.2.3. HLT - Long Tee

Part No.	Tube O.D.D		Tube W.T.T		Dimensions (mm)			Body Cube
	inch	mm	inch	mm	B	L	F	
HLT-04-	1/4	6.35	0.039	1	19	20	25	9
HLT-06-	3/8	9.52		1				11
HLT-08-	1/2	12.7	0.049	1.24		27	15	
HLT-12-	3/4	19.05	0.065	1.65		31.5	22	
HLT-16-	1	25.4	0.065	1.65		34	30	

1.2.4 HLRT - Long Reducing Tee

Part No.	Tube O.D.D		Tube W.T.T		Tube O.D.D1		Tube W.T.T1		Dimensions (mm)			Body Cube
	inch	mm	inch	mm	inch	mm	inch	mm	B	L	F	
HLRT-0604-	3/8	9.52	0.039	1	1/4	6.35	0.039	1	19	25	11	
HLRT-0804-	1/2	12.7	0.049	1.24	1/4	6.35		1				
HLRT-0806-	1/2	12.7	0.049	1.24	3/8	9.52		1		27	15	
HLRT-1204-	3/4	19.05	0.065	1.65	1/4	6.35		1		31.5	22	
HLRT-1206-	3/4	19.05	0.065	1.65	3/8	9.52		1				
HLRT-1208-	3/4	19.05	0.065	1.65	1/2	12.7	0.049	1.24				

HLT

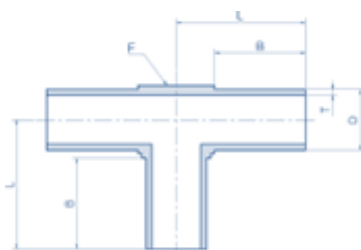

HLRT

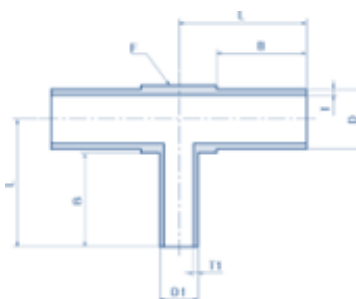

1. WELD FITTINGS

1.2. Weld Fittings - Long

1.2.5. HLRU - Long Reducing Union

Part No.	Tube O.D.D		Tube W.T.T		Tube O.D.D1		Tube W.T.T1		Dimensions (mm)	
	inch	mm	inch	mm	inch	mm	inch	mm	B	L
HLRU-0604-	3/8	9.52	0.039	1	1/4	6.35	0.039	1	19	39
HLRU-0804-	1/2	12.7	0.049	1.24	1/4	6.35		1		
HLRU-0806-	1/2	12.7	0.049	1.24	3/8	9.52		1		
HLRU-1204-	3/4	19.05	0.065	1.65	1/4	6.35		1		
HLRU-1206-	3/4	19.05	0.065	1.65	3/8	9.52		1		
HLRU-1208-	3/4	19.05	0.065	1.65	1/2	12.7	0.049	1.24	19	42.9
HLRU-1604-	1	25.4	0.065	1.65	1/4	6.35	0.039	1		
HLRU-1606-	1	25.4	0.065	1.65	3/8	9.52		1		
HLRU-1608-	1	25.4	0.065	1.65	1/2	12.7	0.049	1.24		44.5
HLRU-1612-	1	25.4	0.065	1.65	3/4	19.05	0.065	1.65		

HLRU

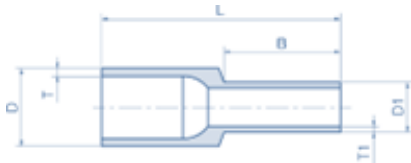



ECM COMPONENTS - FLOWLINK

165 Avenue des Cocardières, ZAC VIA DOMITIA

34160 Castries, France

Tel: +33 (0) 4 67 61 12 02

E-mail: contact@ecmcomponents.com

Website: flowlinksa.com

