

# CV - Series Check Valves

## Standard Check Valves

### Features

#### Design

Standard Moduline dimensions.  
 Various fitting configurations.  
 All tube connections are TIG orbital welded.  
 Other lengths available.

#### Materials

Wetted area ..... 316L Stainless Steel  
 Gasket ..... Viton, EPDM, Kalrez, Nitrile  
 Surface finish .....  $Ra \leq 0,4\mu m$  ;  $Ra \leq 0,2\mu m$  on request

### Ratings

#### Cracking Pressure

CHK 1/3 PSI .....	23 mb
CHK 1/2 PSI .....	34 mb
CHK 1 PSI .....	70 mb
CHK 2 PSI .....	138 mb
CHK 3 PSI .....	207 mb
CHK 5 PSI .....	345 mb

#### Flow Coefficient

Cv ..... starting 0.18

#### Temperature

Operating ..... 0°C to 70°C

#### Pressure

Operating ..... Vacuum to 30 bar

#### Helium Leak Rate

External seating .....  $<5.10^{-10}$  atm cm<sup>3</sup>/s  
 Internal seating .....  $<1.10^{-7}$  atm cm<sup>3</sup>/s

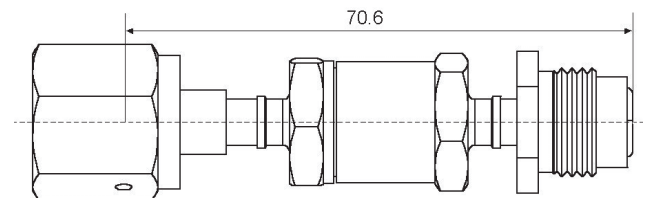

# CV Series – Standard Check Valves

## Part Number Description

